



[IE36]

4" x 2.5" x 2.5" Brass angle roof manifold



4" (100mm) NPT x 2.5" (65mm) NPT x 2.5" (65mm) NPT brass angle roof manifold used as a standpipe roof outlet connection, fire pump test connection, wall hydrant or sidewalk (free standing) by the fire service professions. The body is furnished with female NPT inlet and male NPT outlets. The IE36 provides 250 GPM per outlet.

Dimensions:

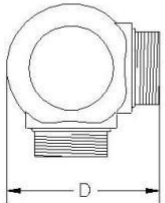
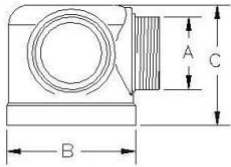

A= 2 1/2" NPT
B= 5" (127mm)
C= 4.75" (120mm)
D= 6" (152mm)

CERTIFICATE OF COMPLIANCE

Certificate Number 20150428-EX26662
Report Reference EX26662-20150223
Issue Date 2015-APRIL-28

Issued to: WILSON & COUSINS, DIV OF PALAMAR INDUSTRIES
UNIT M
4390 PALETTA CT
BURLINGTON, ON L7L 5R2 CANADA

**This is to certify that
representative samples of**

ROOF MANIFOLDS

Roof Manifolds having a rated pressure of 175 psig in the following models, sizes and patterns: IE35, IE36, IE29-63T, IE29-63AT, IE29-64T, IE29-64AT, IE39-A.

Have been investigated by UL in accordance with the Standard(s) indicated on this Certificate.

Standard(s) for Safety: Standard for Fire Department Connection for Fire Protection Service, UL 405.

Additional Information: See the UL Online Certifications Directory at www.ul.com/database for additional information

Only those products bearing the UL Certification Mark should be considered as being covered by UL's Certification and Follow-Up Service.

Look for the UL Certification Mark on the product.



Bruce Mahrenholz, Assistant Chief Engineer, Global Inspection and Field Services

UL LLC

Any information and documentation involving UL Mark services are provided on behalf of UL LLC (UL) or any authorized licensee of UL. For questions, please contact a local UL Customer Service Representative at www.ul.com/contactus

